



USER GUIDE



ENHANCED CAESAREAN SECTION MODULE - PROMPT FLEX

This product is available
in light and dark skin tones

80300

80400

FOR MORE SKILLS TRAINING PRODUCTS VISIT

limbsandthings.com

Sussex Street, St Philips, Bristol, BS2 0RA, UK | sales@limbsandthings.com | +44 (0) 117 311 0500

INDEX

PACKAGE SUPPLIED	3
SAFETY & CLEANING INSTRUCTIONS	4
SET UP	5
• GETTING THE PROMPT FLEX READY	5
- Removing the ABDOMINAL SKIN	
- Removing PELVIC RING CLAMP, CERVIX & PERINEUM	
• SETTING THE MODULE UP FOR IMPACTED FETAL HEAD TRAINING	7
- Adding the IFH Uterus for ECSM - PROMPT Flex	
- Inserting the baby and closing the uterus	
• SETTING PRODUCT UP FOR ROUTINE CEPHALIC & BREECH C-SECTIONS	10
• SETTING UP THE PRODUCT FOR C-SECTION WITH A TRANSVERSE LIE	12
CLEANING & STORAGE	15

TAKE A LOOK AT OUR
PROMPT FLEX VIDEO



VISIT THE WEBSITE
limbsandthings.com

OR YOUTUBE CHANNEL
youtube.com/limbsandthings

PACKAGE SUPPLIED

Perineum for ECSM and CD&E Modules

80138

80238



Foam uterus support for ECSM

80175



Impacted Fetal Head Uterus for ECSM

80301

80401



Pelvic Floor for ECSM

80302

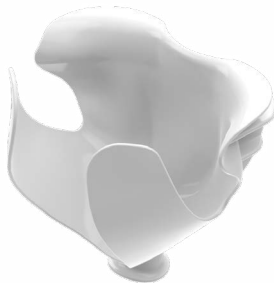

Uterus for ECSM

80170

80270



Pre-incised Delivery Skin for ECSM

80303

80403



Cervix for ECSM

80173



YOU'LL NEED (NOT SUPPLIED)

Birth Simulator - PROMPT Flex

80100

80200

80106

80206



* this module requires the enhanced standard baby (80121/80221)

SAFETY & CLEANING INSTRUCTIONS

READ THE SAFETY INSTRUCTIONS CAREFULLY BEFORE USING YOUR ENHANCED CAESAREAN SECTION MODULE - PROMPT FLEX

DO's



Follow all instructions. Keep these instructions. Heed all warnings.

Wear gloves at all times and remove all jewellery items. Sharp surfaces such as finger nails and rings can lead to damage of silicone parts.



Use L&T branded lubricant with this product. Use of non-recommended fluid products may weaken or damage the simulator.

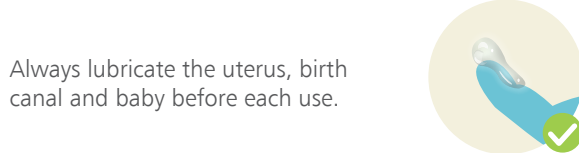

Always lubricate the uterus, birth canal and baby before each use.



Clean the product with a soft damp cloth or sponge, using only warm water with mild detergent, after every training session.

DON'Ts



Do not install near any heat sources, do not expose the product to flames or use near a naked flame source. Do not use flammable solvents near or on this product.

Do not use any attachments other than those supplied by the manufacturer.



Do not disassemble the product or attempt to repair a faulty unit, please return the product to Limbs & Things for assessment and repair.

Do not allow young children to use this product.



STORAGE & TRANSPORTATION



Always ensure the product is carefully packed and secured during transportation and storage in order to prevent personal injury or damage to the product.

SET UP

GETTING THE PROMPT FLEX READY

Removing the ABDOMINAL SKIN

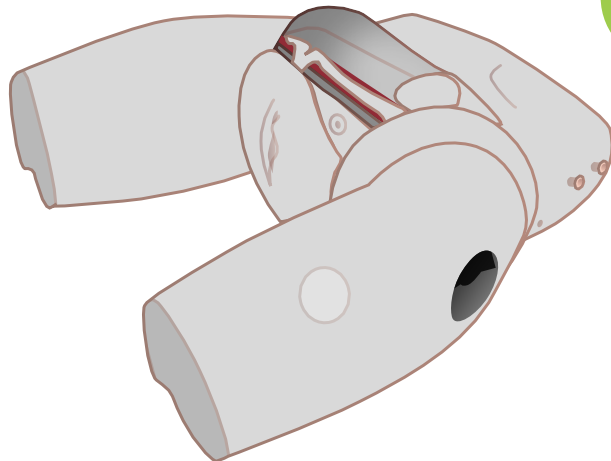
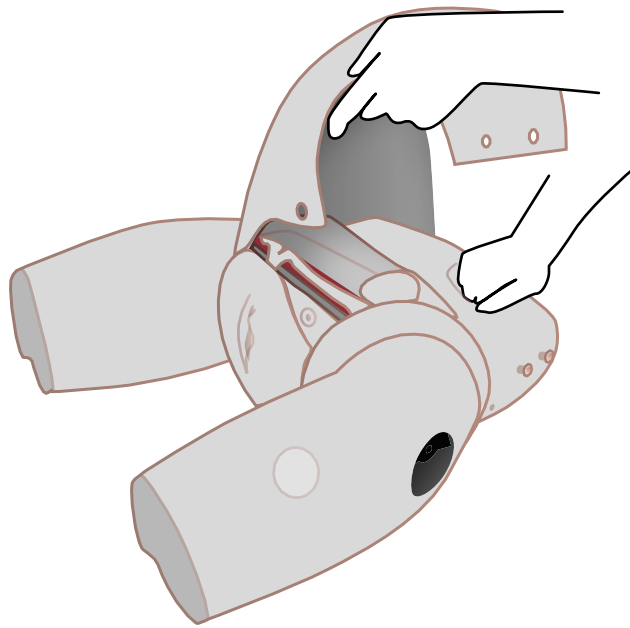
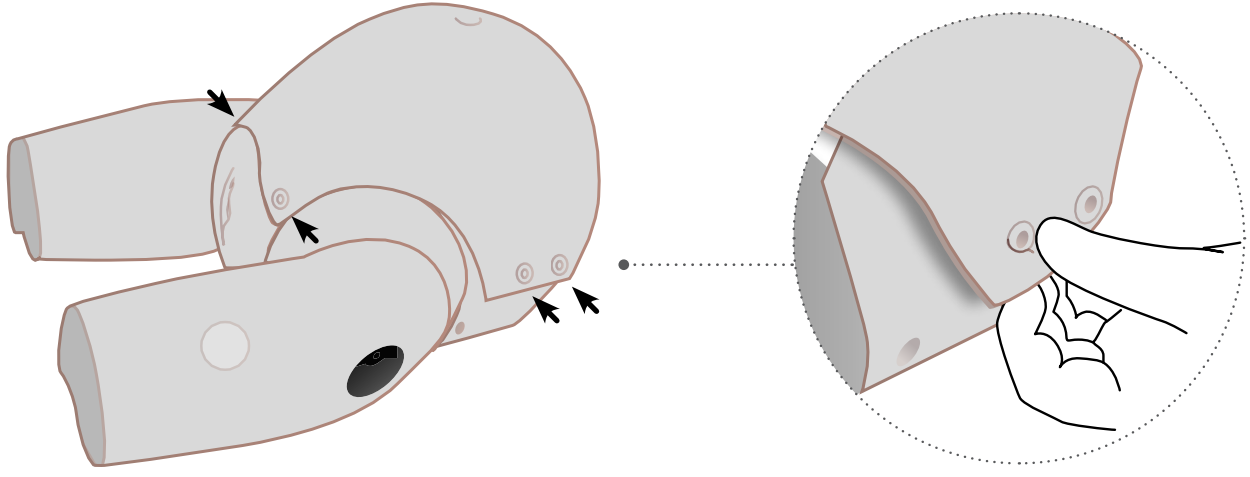

SET UP

GETTING THE PROMPT FLEX READY

Removing PELVIC RING CLAMP, CERVIX & PERINEUM

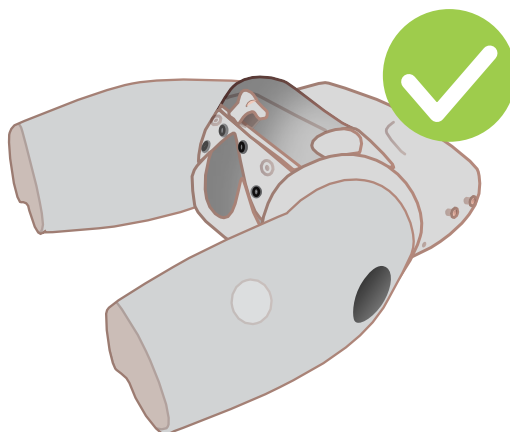
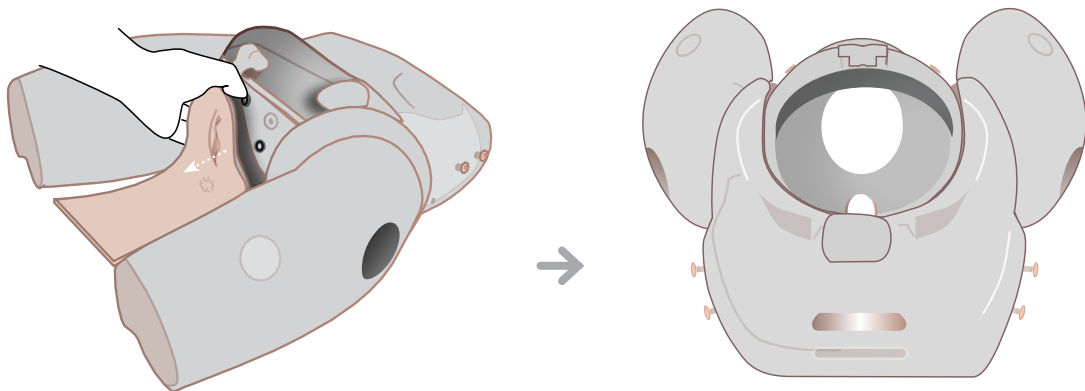
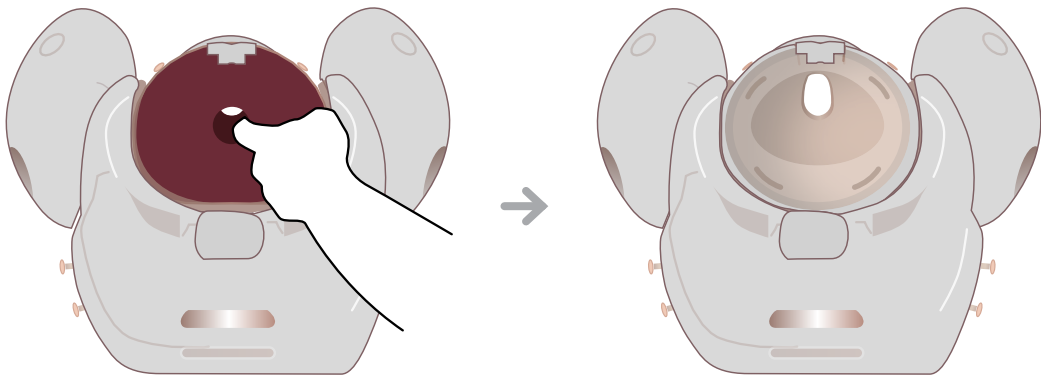
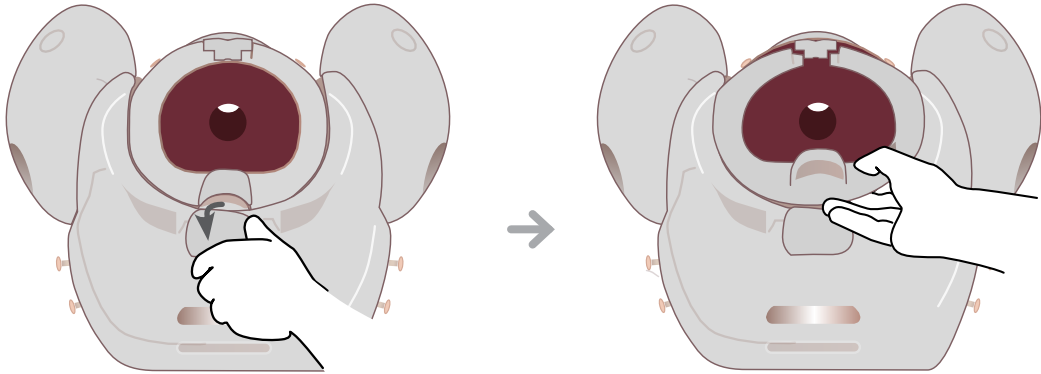

SET UP

SETTING THE MODULE UP FOR IMPACTED FETAL HEAD TRAINING

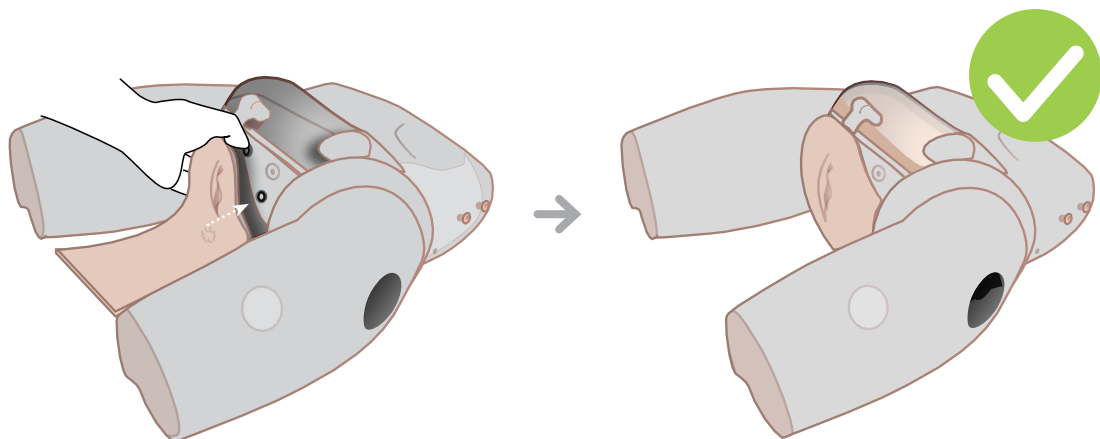
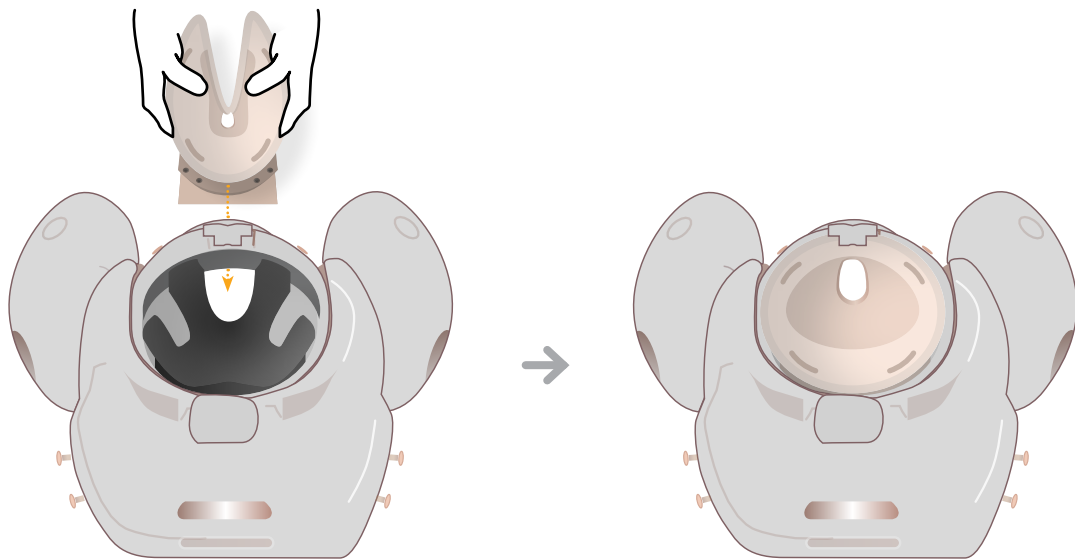
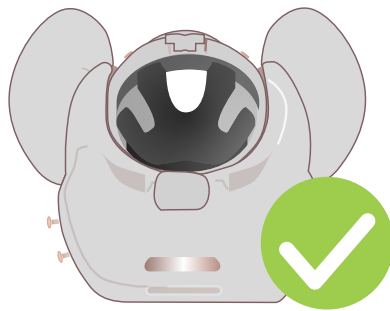
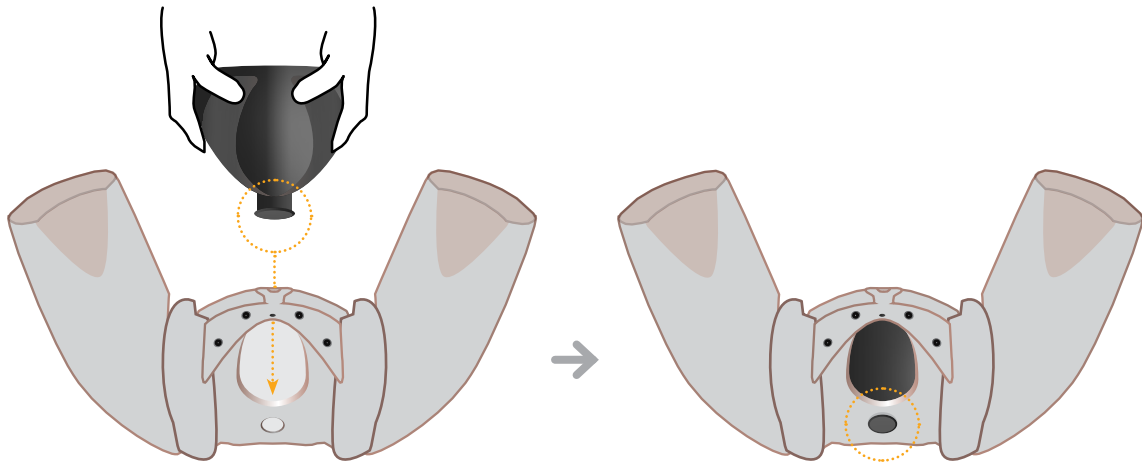

SET UP

SETTING THE MODULE UP FOR IMPACTED FETAL HEAD TRAINING

Adding the IFH Uterus for ECSM - PROMPT Flex

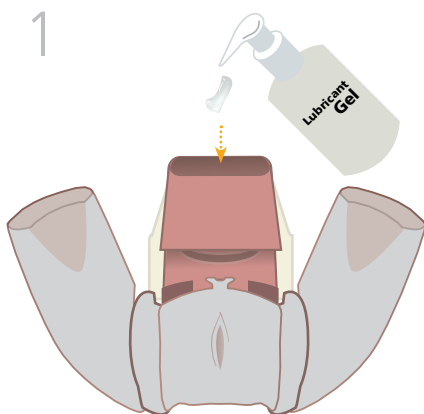
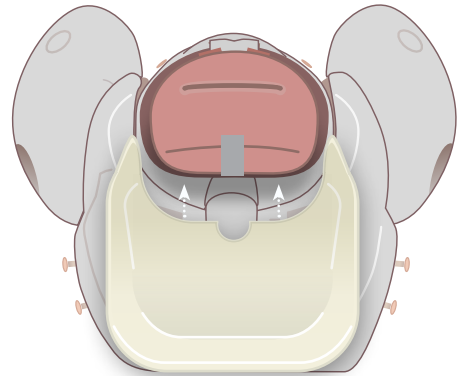
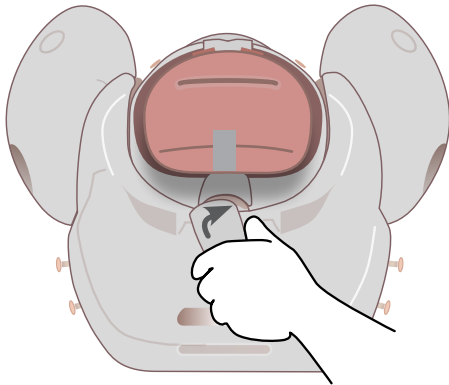
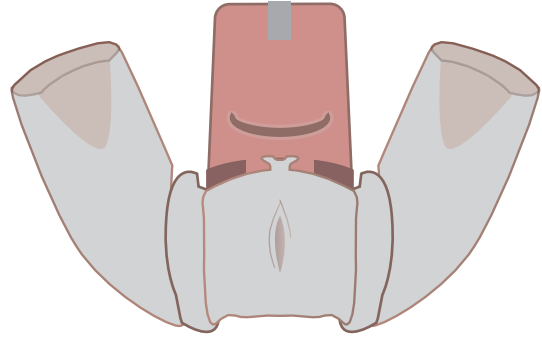
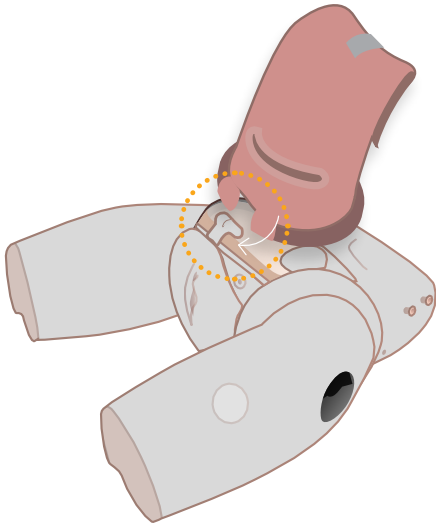

SET UP

SETTING THE MODULE UP FOR IMPACTED FETAL HEAD TRAINING

Inserting the baby and closing the uterus

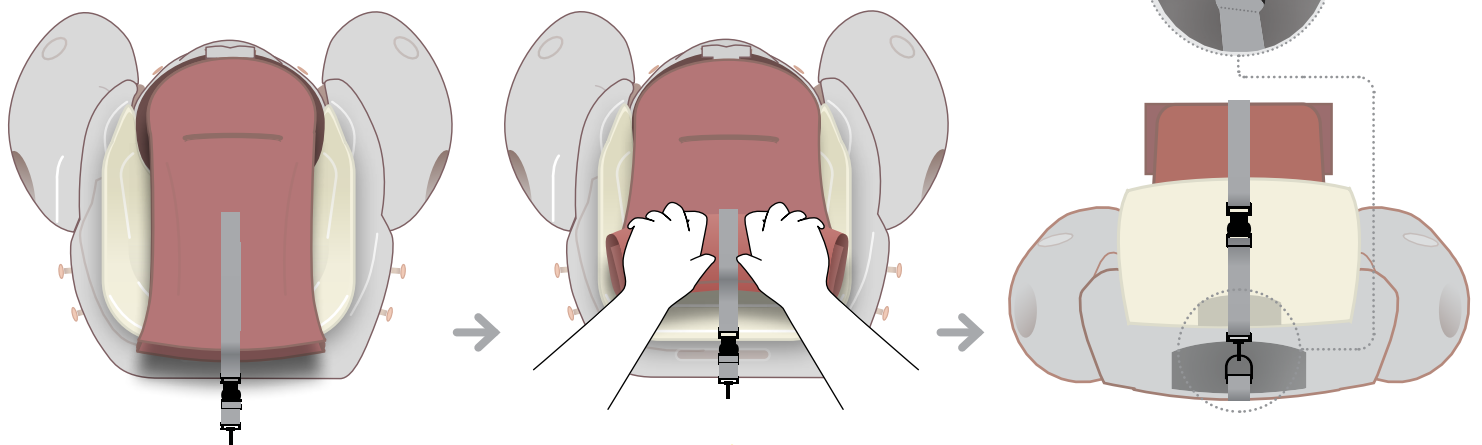
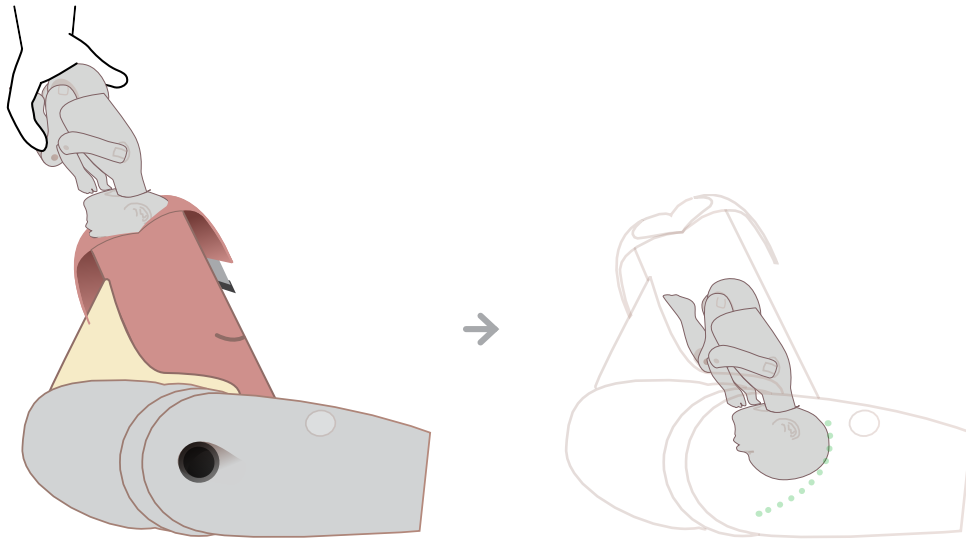

Do not add skin if using to teach Patwardhan's technique

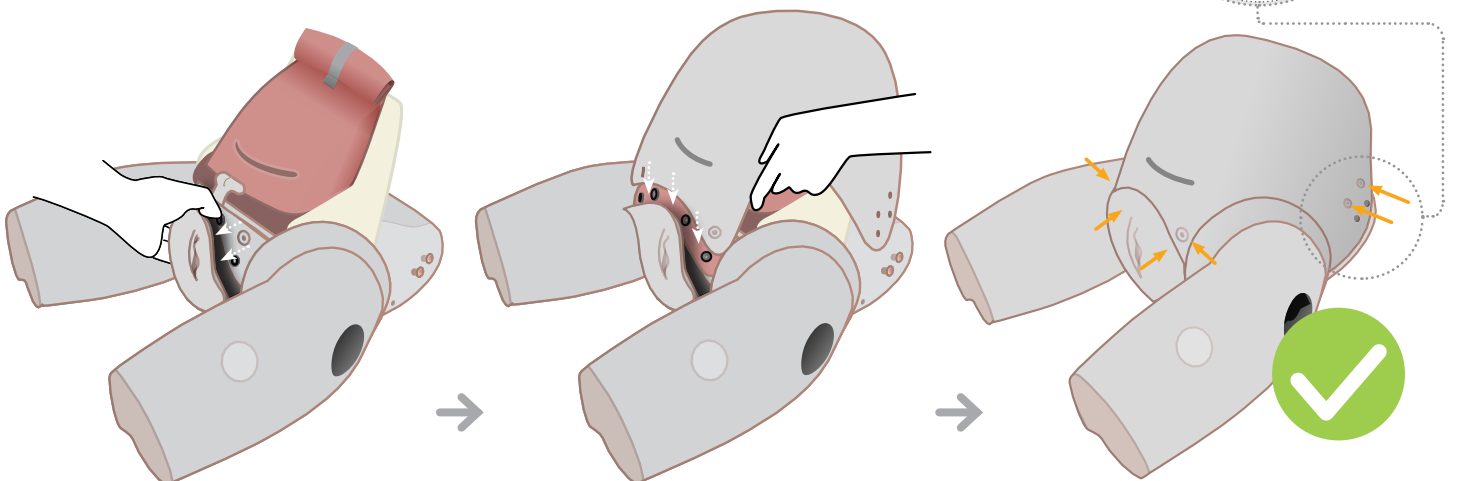
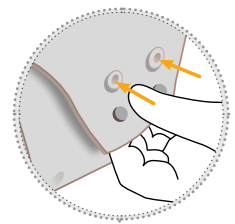

SET UP

SETTING PRODUCT UP FOR ROUTINE CEPHALIC & BREECH C-SECTIONS

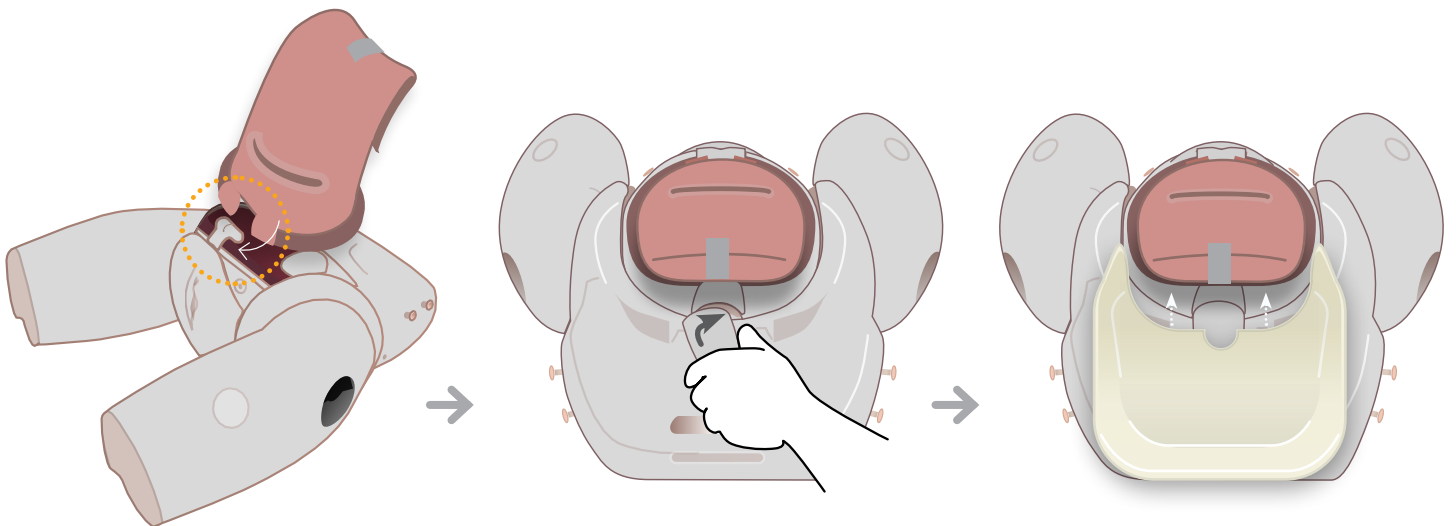
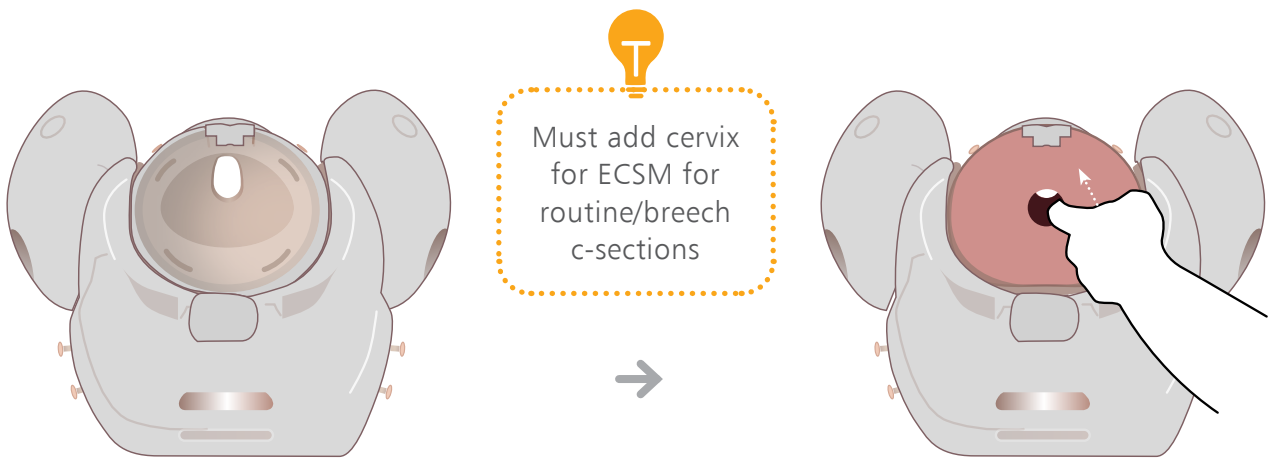
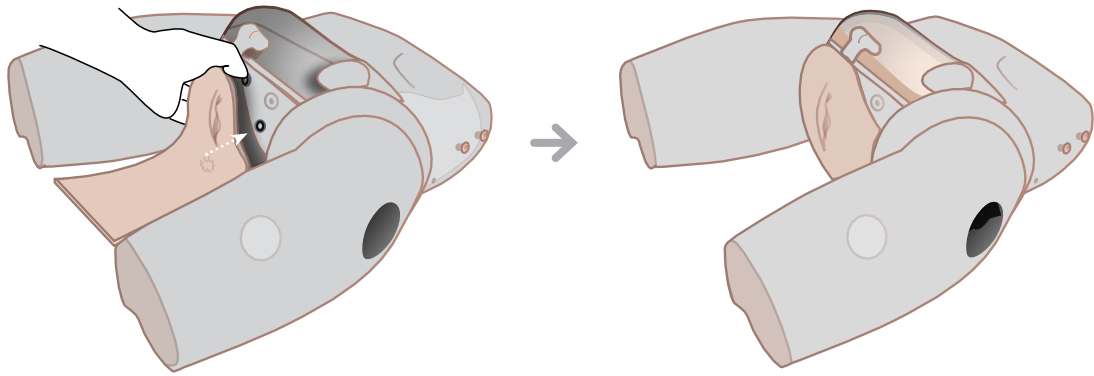

SET UP

SETTING PRODUCT UP FOR ROUTINE CEPHALIC & BREECH C-SECTIONS

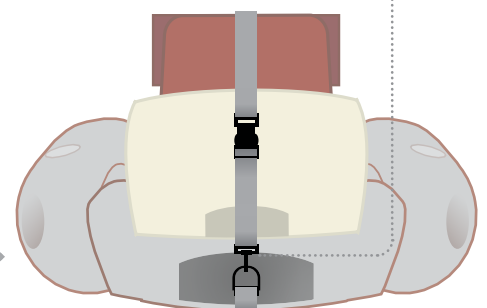
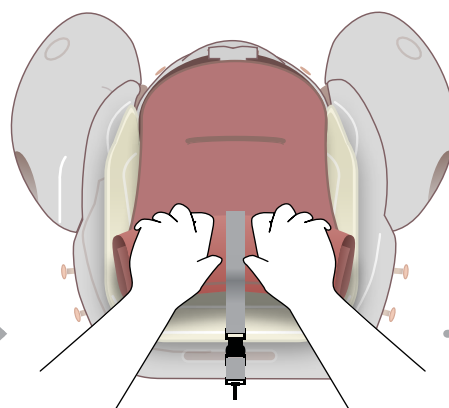
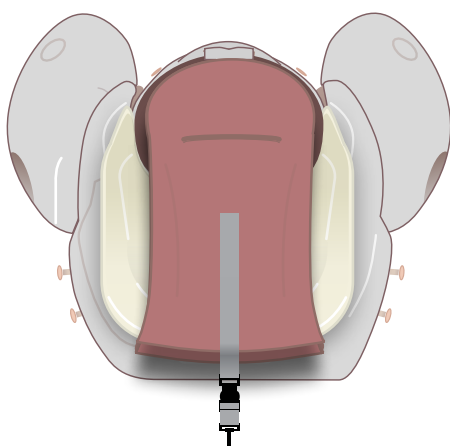
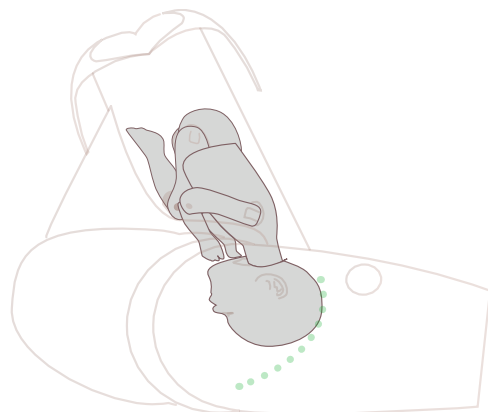
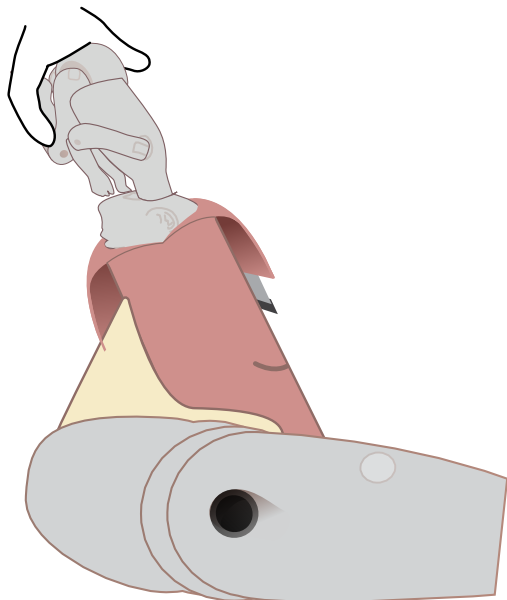
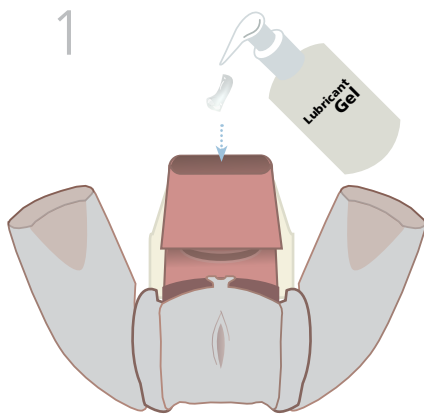

SET UP

SETTING PRODUCT UP FOR TRANSVERSE LIE

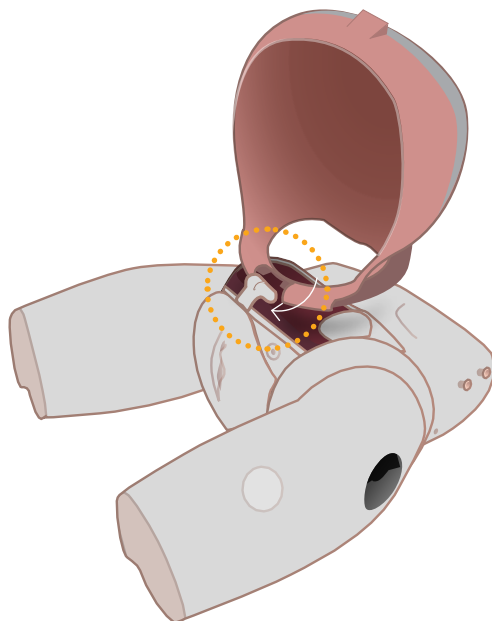
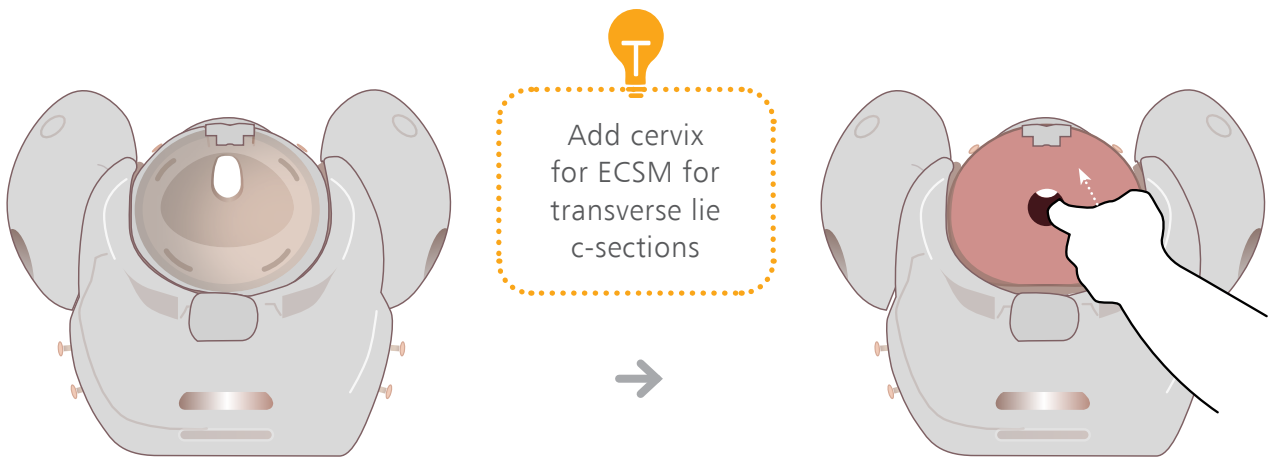
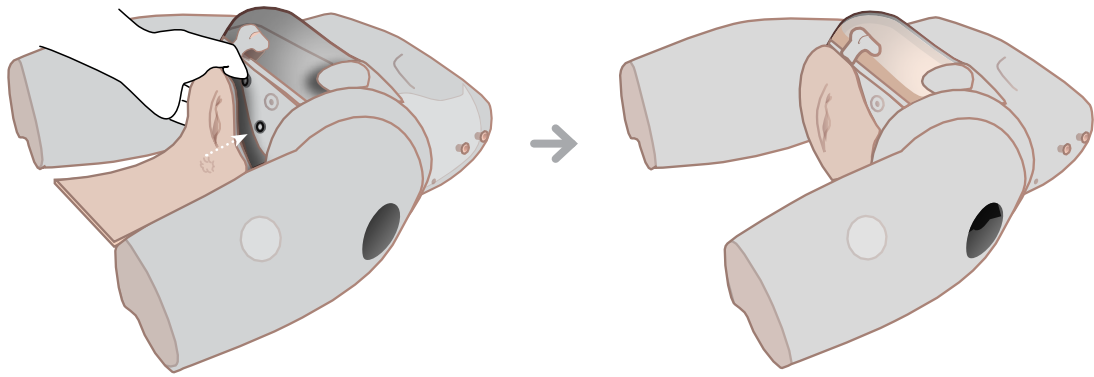

SET UP

SETTING PRODUCT UP FOR TRANSVERSE LIE

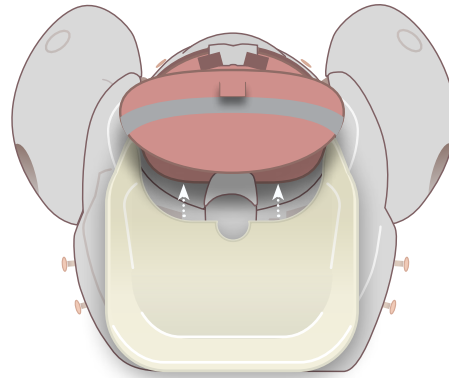
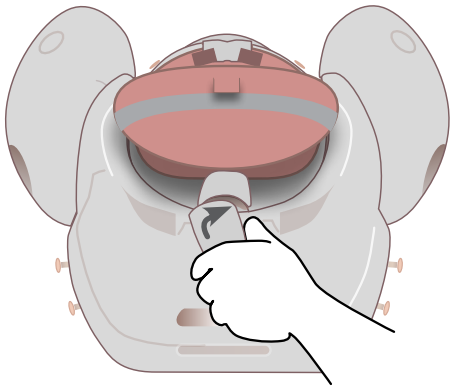

1

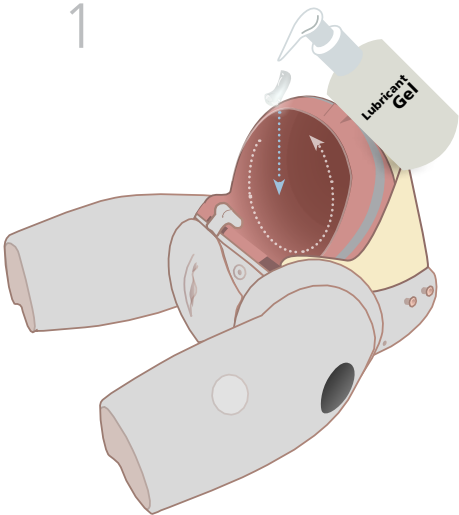

2

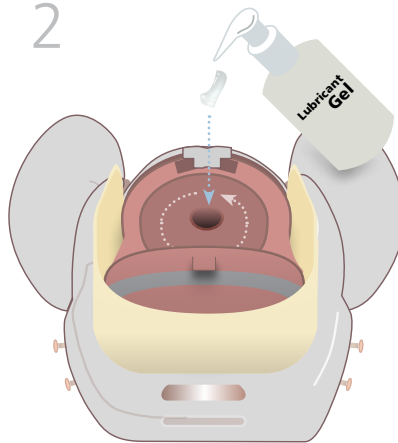

3

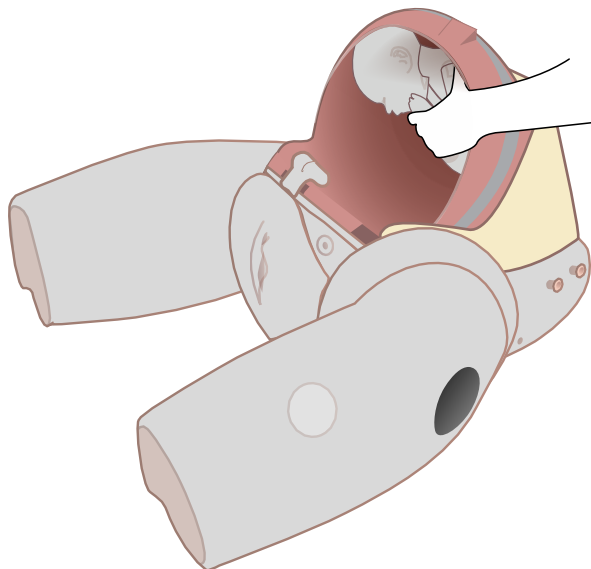

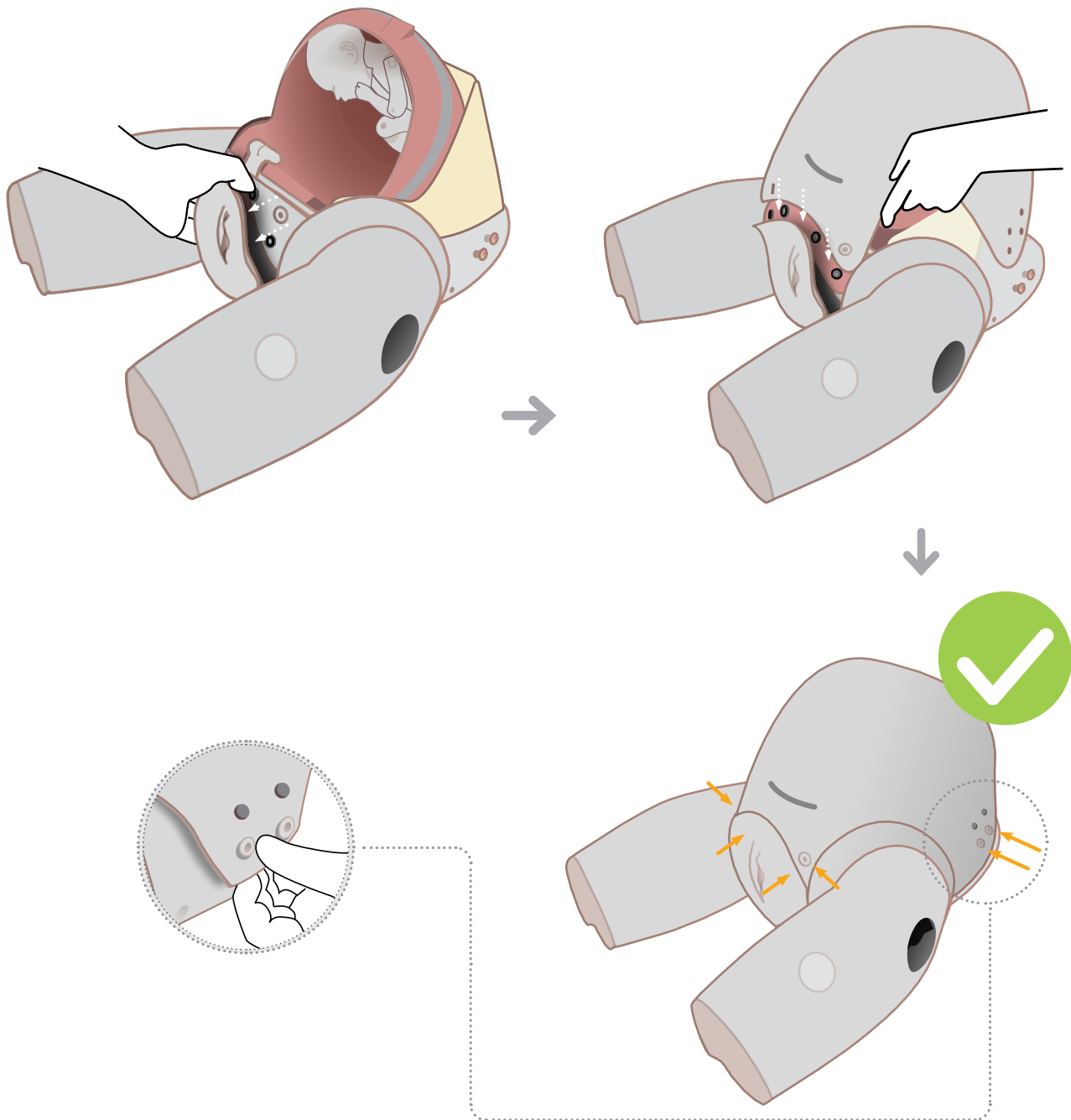

CLEANING & STORAGE

ADDING/REMOVING PERINEUM

After each training session, clean all the lubrication from all mother and baby surfaces with a warm damp cloth.

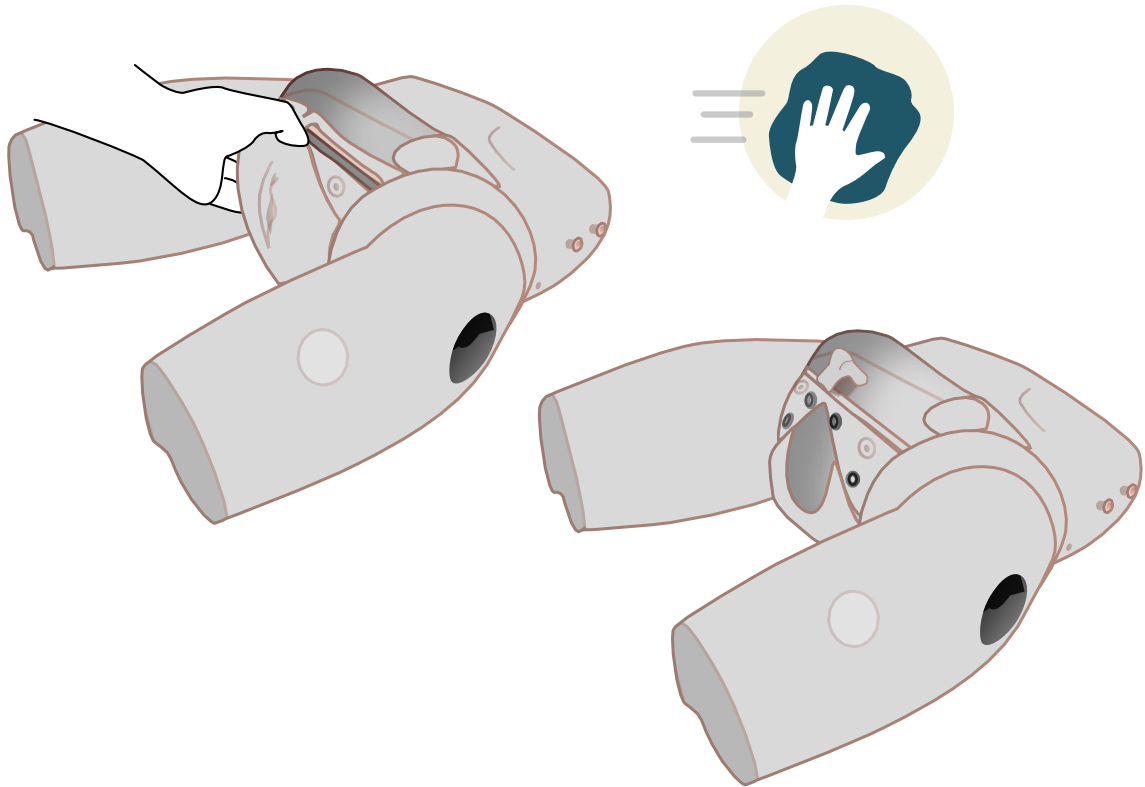

We recommend using the ENHANCED CAESAREAN SECTION MODULE with the PROMPT FLEX legs.



This module requires the Enhanced Standard Baby and Birthing Simulator PROMPT Flex



ADDITIONAL MODULES *
ALLOW YOU TO TAILOR
YOUR TRAINING NEEDS

LOWER LEGS -
PROMPT FLEX



CERVICAL
CERCLAGE

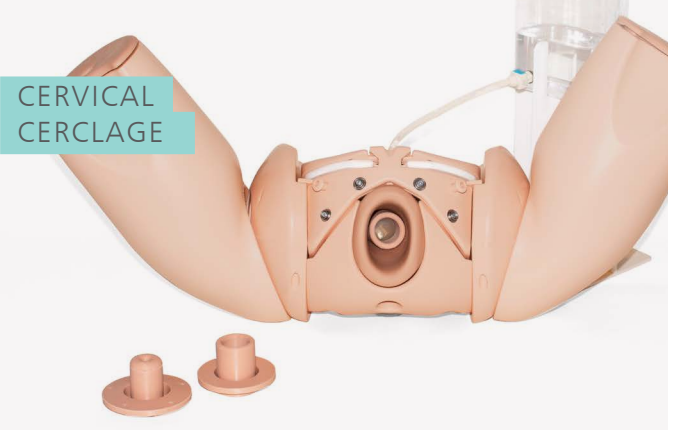

CERVICAL
DILATATION
& EFFACEMENT



PPH

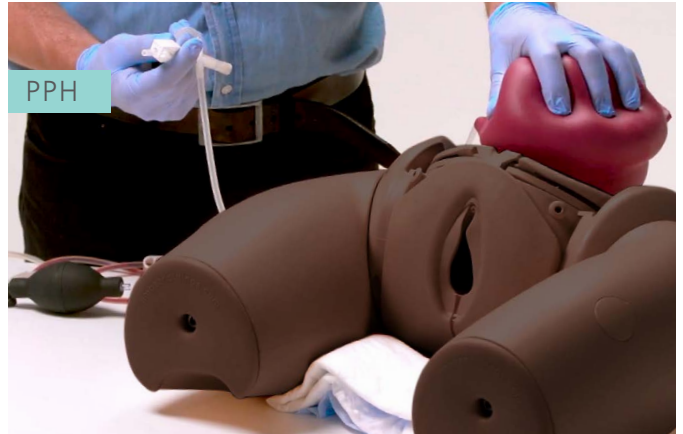

COMPRESSION
SUTURE UTERUS

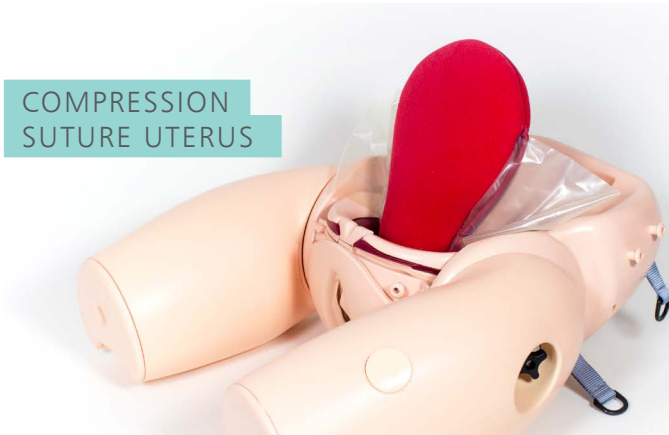

* All available in dark and light skin tones.